



February 2018

www.fitzroyhistorysociety.org.au

President: Peter Woods

NEWSLETTER

P.O. Box 180, Fitzroy, 3068

fitzroyhistorysociety@yahoo.com.au

Secretary: Meg Lee

UPCOMING EVENT

Join us on Sunday 11 March at 10.30 am for a guided walk, entitled **MADE IN NORTH FITZROY**

Meet at the small triangular shaped reserve/park bounded by Alexandra Parade, Queens Parade and Napier Street, opposite the swimming pool and on the north side of Alexandra Parade. This is the former site of the Isabel Henderson Kindergarten (Melways map 2C, C4). The walk will take approximately 2 hours.

The walk explores the history of manufacturing in the southern part of Queens Parade, North Fitzroy. In particular it focuses on four significant manufacturing industries established near the previous Fitzroy railway station and goods yards.

Terence Nott, long time North Fitzroy resident, local architect and member of the Fitzroy History Society will lead the walk. During the walk Terence will be referring to the booklet *Half Drowned or Half Baked*, recently published by the FHS. Copies of the booklet will be available to purchase during the walk. Those who have a copy are advised to bring it with them for the walk. A4 sized handouts describing the main features of the walk will be provided.

Quarries in North Fitzroy

The proclamation of 1860 that separated most of present-day North Fitzroy from the City of Melbourne and annexed it to Fitzroy referred to the area as the Quarries District (Victoria Government Gazette, no. 96, 3 August 1860, p. 1459). Early maps have not shown the quarries, but the 1867 map below shows the outlines of four small quarries (arrowed) in the area bounded by Nicholson, Scotchmer (the unnamed northern street on the map), Rae (the north-south street in the centre) and Reid Streets.

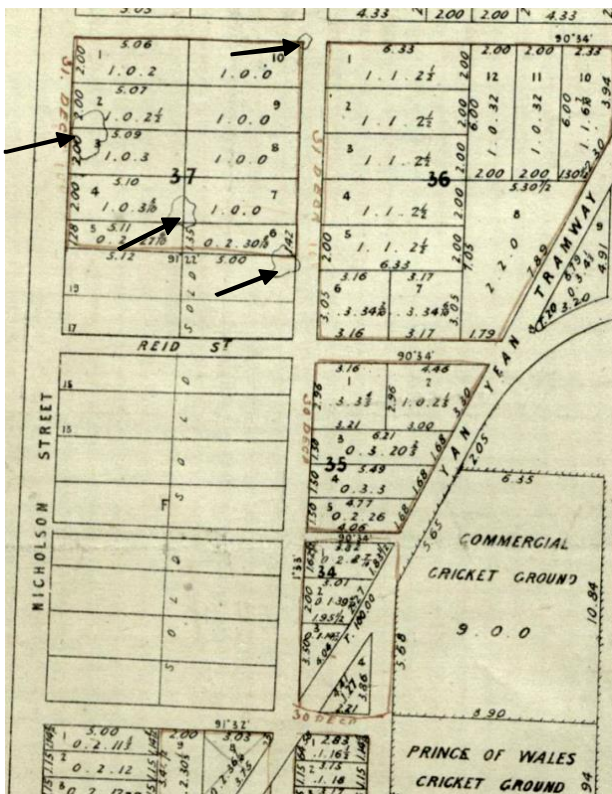

Portion of Dept. of Lands & Survey map October 1867 (<http://handle.slv.vic.gov.au/10381/166338>).

In 1871 some quarries were being filled in. 'The men who have filled in the Fitzroy quarry-holes at the rate of pay fixed by the Government, viz., four shillings and sixpence for eight hours labor, . . .' (Leader [Melbourne], 2 December 1871, page 6).

The largest quarry remained in 1882 on Nicholson St, about 100 m south of Scotchmer St and the Empress Hotel. 'There is a very dangerous man trap in Nicholson Street, a short distance from the Empress of India Hotel, in the shape of a large quarry hole quite close to the footpath. Between a portion of the hole and the path there is a half apology for a fence, but on the other sides, to which access is easily obtained by various paths, there is none whatsoever.' (Fitzroy City Press, 25 March 1882, page 3).

'Residents of Rae-street and Nicholson-street, between Reid and Scotchmer-streets complain of the stench arising from the old quarry holes there. They are made the receptacles for all kinds of dead and decaying animal and vegetable matter, and must be detrimental to the health of the neighbourhood. It is to be hoped that some of the material obtained by the cutting down of Michael and other streets will be used to fill up these dangerous and unsightly holes.' (Fitzroy City Press, 17 March 1883, page 3).

'... a memorial from 43 residents of North Fitzroy, complaining of a dangerous quarry hole between Nicholson and Rae streets, north of Reid-street, dangerous to health and safety.' (Fitzroy City Press, 15 December 1883, page 3).

'... that an order be made on O. N. Nicholson, to suppress a nuisance arising from the filling up his quarry hole, situate between Rae and Nicholson-streets and Reid and Scotchmer-streets, with filthy substances.' (Fitzroy City Press, 13 June 1885, page 3).

'That the application of Mr. J. E. Phillips for permission to fence in footpath in Nicholson-street. at the quarry sites, during the erection of a retaining wall has been referred to the Surveyor to issue the usual permit for building purposes.' (Fitzroy City Press, 24 December 1887, page 3).

Also of interest on the map, is the diagonal route of the Yan Yean Tramway, that was to become St Georges Road.

— M. Moore

PAST EVENTS

HALF-DROWNED or HALF-BAKED, a seminar on North Fitzroy history



Speakers at the seminar, from left: Mike Moore, Tim Gatehouse, Cr. Jackie Fristacky, Gil Langfield, Peter Woods, Meg Lee, Terry Knot, Miles Lewis.

On Sunday, 3 December 2017 an audience of about 50 attended this seminar in the large meeting room at the new North Fitzroy Library (Bargoonga Nganjin). The seminar title is a quotation on North Fitzroy by the writer 'Garryowen' in his Chronicles of Early Melbourne.

Following an opening address by Nicholls Ward councillor Jackie Fristacky, eight papers were presented by seven speakers.

The Planning of North Fitzroy by Miles Lewis details the planning and land settlement in the area, including the planned but unexecuted subdivision of Merriville, and concludes with an account of the attempt by the Housing Commission to clear the 'slums' of the Brooks Crescent area.

North from Holden Street to Glenlyn Road by Mike Moore is an account of the northward expansion of the suburb into what had previously been Brunswick and describes a number of significant buildings in the area.

Made in North Fitzroy by Terence Knot is an account of some of the manufacturing industry in the area which included boot factories, metal and silverware production, metal can fabrication, gas works and, during WWII, the production of various army vehicles and munitions.

Milk—and How it Changed the Landscape by Meg Lee and Alison Hart gives an account of the distribution of milk from the time when there were many local dairies in North Fitzroy and the changes in the regulation of milk quality.

Yan Yean Pipeline and St Georges Road by Peter Woods recounts the construction of the reservoir on the Plenty River and the pipeline to the service reservoir at Reservoir and onward to Melbourne. The wooden tramway that was built to transport the cast iron pipes and other equipment by horse-drawn carts became the route of St Georges Road.

Howe Street Subdivision of North Fitzroy by Tim Gatehouse gives a detailed history of the ownership and occupation of the land centred on this cul-de sac off Michael Street, including the Presbyterian Church on Michael Street.

Rags to Riches—Norwich, England to Freeman Street, Fitzroy by Gil Langfield tells the story of Emma Bagshaw, who became an owner of properties in Freeman Street and elsewhere after emigrating from poor circumstances in Norwich.

The J H Porter Building by Miles Lewis describes a prefabricated building of international significance that was relocated to its present site the Yarra Council depot in Queens Parade probably in the 1930s. The paper describes other Porter buildings that once existed in Victoria and gives a detailed account of the Porter company.

The proceedings are available in an A4-sized book of 146 pages for \$20 from members of the FHS Committee. They can be contacted at fitzroyhistorysociety@yahoo.com.au.



Tim Gatehouse speaking at the seminar.

Duke of Edinburgh's visit 150 years ago



H.R.H. Prince Alfred, Duke of Edinburgh

Prince Alfred, the Duke of Edinburgh and second son of Queen Victoria visited Victoria over November-December 1867, travelling on his frigate HMS Galatea. The Fitzroy Council commemorated his visit by naming the Edinburgh Gardens and the adjacent Alfred Crescent.

The Age (November 27 1867, page 7) reported the decorations in Fitzroy under the heading:

THE LIGHTS AT COLLINGWOOD AND FITZROY.

The attractions of the city for a time almost depopulated the suburbs of Fitzroy and Collingwood. The loyalty of the residents was however shown in the display of devices in gas and transparencies, which sufficiently indicated the interest taken in the Prince's visit to Victoria.

BRUNSWICK-STREET.

Mr Durrell, of the National Hall Hotel, displayed several transparencies, prominent amongst which were a figure of the Galatea at sea, with the motto 'God Speed,' and also a likeness of the Duke. At the Belvidere Hotel there was lighted up a transparency of Britannia. At the Brunswick Hotel and at the Oddfellows' Arms there were large stars in gas. Mr Newman, confectioner, exhibited a transparency of the Prince, and Mr G. Weelstead, grocer, a star reflector. At the Labor in Vain Hotel there was another star, and Mr F. Graham, importer, showed several transparencies.

NAPIER-STREET.

In the front of the Fitzroy Council Chambers there was a large star in gas, and the building was also gaily decorated with evergreens and flowers. A very pretty little model of the Galatea was placed on the top of the porch, which was covered with variegated lamps. Mr Snadden, of the Buck's Hotel, displayed a large gas star; and Mr Groom, of the Napier Hotel, a reflector star.

GERTRUDE-STREET.

Mr Pearson, of the Swan Hotel, had a transparency of the Australian coat of arms, with the words 'Advance Australia.' At the Derby Hotel, there was a transparency of the Duke, and a number of variegated lamps. Mr Rolls, of the Freemasons' Hotel, showed the Foresters' banner; and Mr Simson, of the Rob Roy Hotel, a star reflector. Messrs C. and S. Career, butchers, displayed a star in gas; and Mr Walters, butcher, a transparency of the Prince. Messrs Walton Brothers, chemists, lighted up figures, of the Duke and the Galatea. Mr J. H. Clarke, grocer, had a transparency of the Duke's coat of arms encircled by the words 'Welcome, Auld Reekie's Duke;' Mr Fawcett, tailor, a star reflector; Messrs Ross and Smith, grocers, the crown and the letters P.A. in gas; and Mr Boland, of the Champion Hotel, a star in gas. The National Bank had a line of gas extending across the front part of the building; and the English, Scottish and Australian Chartered Bank, a large star reflector.

Additional on-line history resources at the State Library of Victoria

The Sands & McDougall Directories at 5 year intervals, are now on-line over the period 1860 to 1974.

They can be found using the search facility on the SLV website, or directly at:

http://cedric.slv.vic.gov.au/R/?func=collections&collection_id=3907

There are 17 other collections also now on-line They include:

- Melbourne street directories, 1912-1952
- Robert K Cole Index of Victorian hotels
- Victorian historical journal, 1911-2012
- World War I unit histories
- The Australian medical gazette, 1869-1871

They can be accessed directly at:

<http://cedric.slv.vic.gov.au/R/GOYUC1K26R2FCXVQS9BXCICUH9U3XK2C9FPQC372KSJLBJYND8E-02029?func=search>

The Newsletter is commonly written by members of the Committee, but we welcome contributions by other FHS members. If you need help in how to get started, speak to a member of the Committee.

FACEBOOK

FHS is now on FACEBOOK Find us at www.facebook.com/fitzroyhistorysoc

Become a Member

Membership costs just \$10 per person per year.

To make renewal easy, all memberships fall for renewal on 1 August each year (around the date of our AGM). If you would like to join or renew your membership, please complete the form found in this newsletter or on our website www.fitzroyhistorysociety.org.au and send it with the membership fee to PO Box 180, Fitzroy, 3065.

If you have any queries email us at fitzroyhistorysociety@yahoo.com.au or write to us at PO Box 180, Fitzroy, 3065.

We look forward to having you as a member.

To help us keep our mailing costs down, please consider receiving your Newsletter by email.

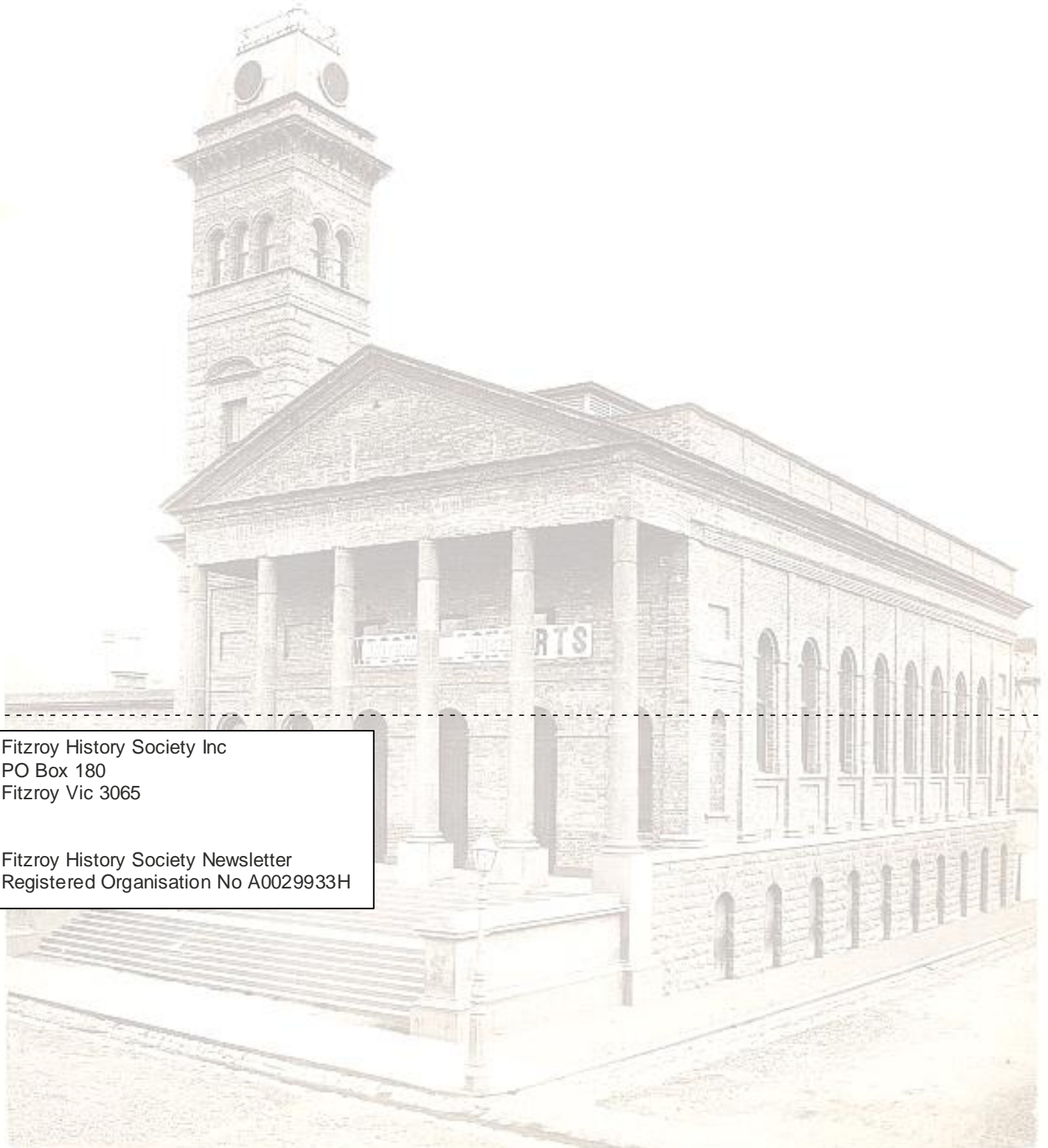

Fitzroy History Society Inc
PO Box 180
Fitzroy Vic 3065

Fitzroy History Society Newsletter
Registered Organisation No A0029933H